

# MESH SPECIFICATIONS

Stock Code: SE620-500SMALL



Product Description: **SE620-500SMALL**

**XTRA-DUCTILE MESH (4.65M X 2.02M)**

Yield Stress:  $\geq 500 \text{ MPa}$

Cross Section: **146.1 mm<sup>2</sup>/m**

KN per metre width: **73 KN/m width**

Uniform Elongation:  $\geq 10\%$

Weight per SQM: **2.29 kg/m<sup>2</sup>**

Nett Cover: **7.92m<sup>2</sup>**

	LONG WIRE	CROSS WIRE
WIRE DIA (mm)	6.1	6.1
CENTRES (mm)	200	200
LENGTH (mm)	4650	2020
No. of WIRES	11	24
O/HANG (mm)	25	10
GROSS WEIGHT PER SHEET (Kg)	22.86	
WIRE KG/m	0.229	0.229
WEIGHT (Kg)	11.73	11.12
GROSS SHEET AREA (m <sup>2</sup> )	9.39	

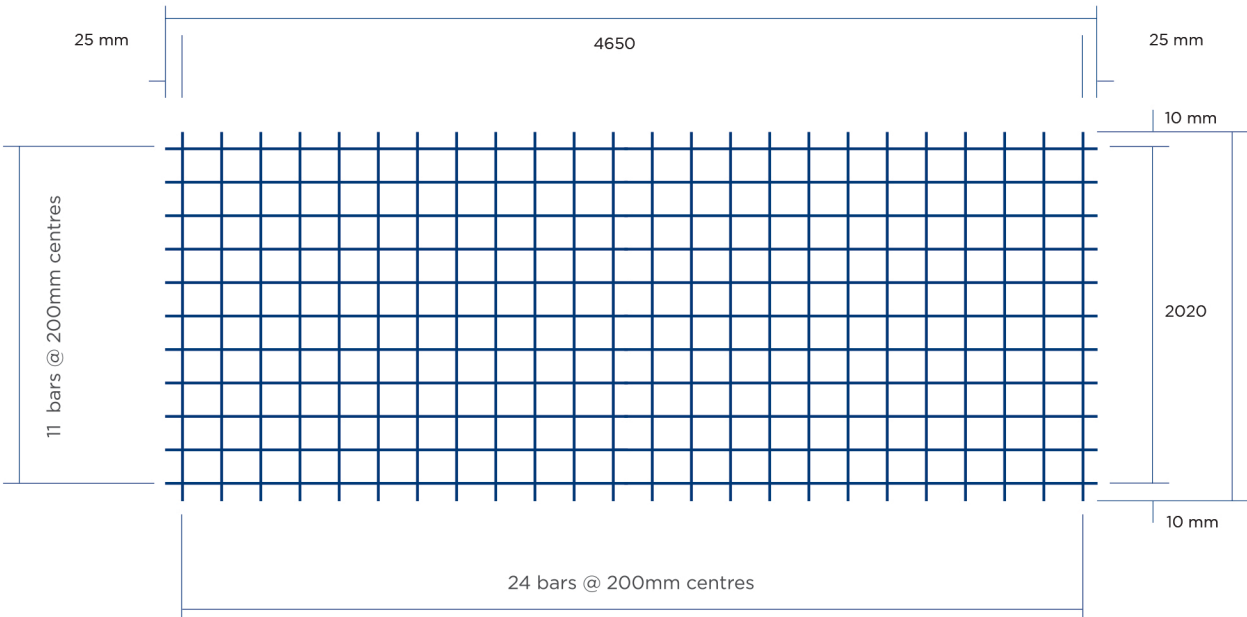

NB: Diagrams not to scale

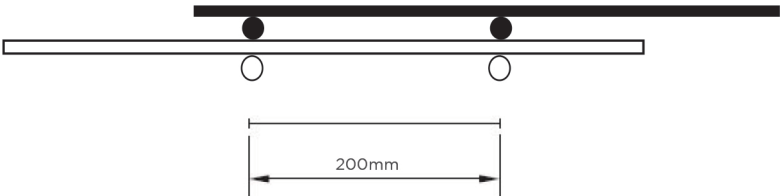

Each batch of Summit Steel & Wire Xtra-Ductile mesh undergoes rigorous testing to meet the AS/NZS 4671:2019 standard. Upon request, we provide batch test certificates for your records. Each mesh sheet comes with a unique identification tag that includes the product code and batch number, ensuring easy traceability. Please ensure this tag remains attached during installation. Standard lapping follows NZS 3101-2:2006, Clause 8.7.6 guidelines. Our 200mm splice length as shown above is an alternative solution having been tested and independently validated. Users must ensure that the correct splice is verified for each specific application.

# MESH SPECIFICATIONS

Stock Code: SE620-500LGE



Product Description: **SE620-500LGE**  
**XTRA-DUCTILE MESH (6.05M X 2.42M)**  
Yield Stress:  $\geq 500$  MPa  
Cross Section: **146.12 mm<sup>2</sup>/m**  
KN per metre width: **73 KN/m width**  
Uniform Elongation:  $\geq 10\%$   
Weight per SQM: **2.29 kg/m<sup>2</sup>**  
Nett Cover: **12.76m<sup>2</sup>**

	LONG WIRE	CROSS WIRE
WIRE DIA (mm)	6.1	6.1
CENTRES (mm)	200	200
LENGTH (mm)	6050	2420
No. of WIRES	13	31
O/HANG (mm)	25	10
GROSS WEIGHT PER SHEET (Kg)	35.25	
WIRE KG/m	0.229	0.229
WEIGHT (Kg)	18.04	17.21
GROSS SHEET AREA (m <sup>2</sup> )	14.64	

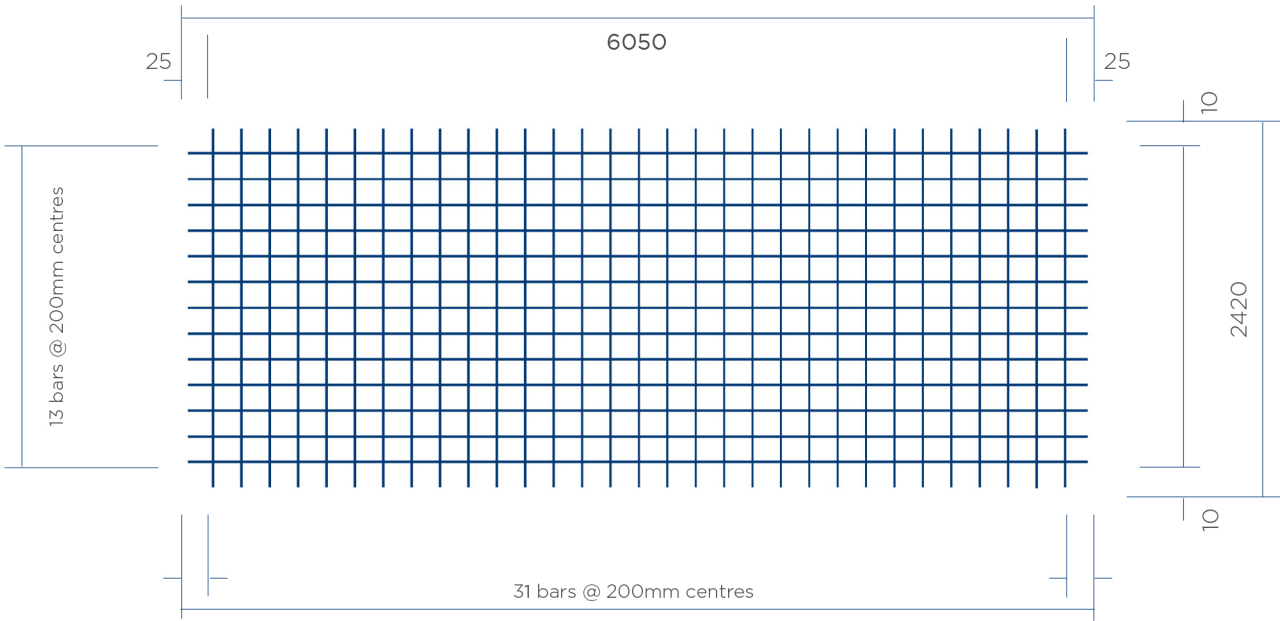

NB: Diagrams not to scale

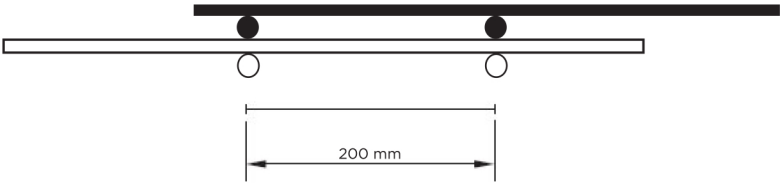

Each batch of Summit Steel & Wire Xtra-Ductile mesh undergoes rigorous testing to meet the AS/NZS 4671:2019 standard. Upon request, we provide batch test certificates for your records. Each mesh sheet comes with a unique identification tag that includes the product code and batch number, ensuring easy traceability. Please ensure this tag remains attached during installation. Standard lapping follows NZS 3101-2:2006, Clause 8.7.6 guidelines. Our 200mm splice length as shown above is an alternative solution having been tested and independently validated. Users must ensure that the correct splice is verified for each specific application.

# MESH SPECIFICATIONS

Stock Code: SE720-500LGE



Product Description: **SE720-500LGE**

**XTRA-DUCTILE™ MESH (6.05M X 2.42M)**

Yield Stress: **≥ 500 MPa**

Cross Section: **192 mm<sup>2</sup>/m**

KN per metre width: **96 KN/m width**

Uniform Elongation: **10%**

Weight per SQM: **3.02 kg/m<sup>2</sup>**

Nett Cover: **12.76m<sup>2</sup>**

	LONG WIRE	CROSS WIRE
WIRE DIA (mm)	7.0	7.0
CENTRES (mm)	200	200
LENGTH (mm)	6050	2420
No. of WIRES	13	31
O/HANG (mm)	25	10
GROSS WEIGHT PER SHEET (Kg)	46.42	
WIRE KG/m	0.302	0.302
WEIGHT (Kg)	23.76	22.66
GROSS SHEET AREA (m <sup>2</sup> )	14.64	

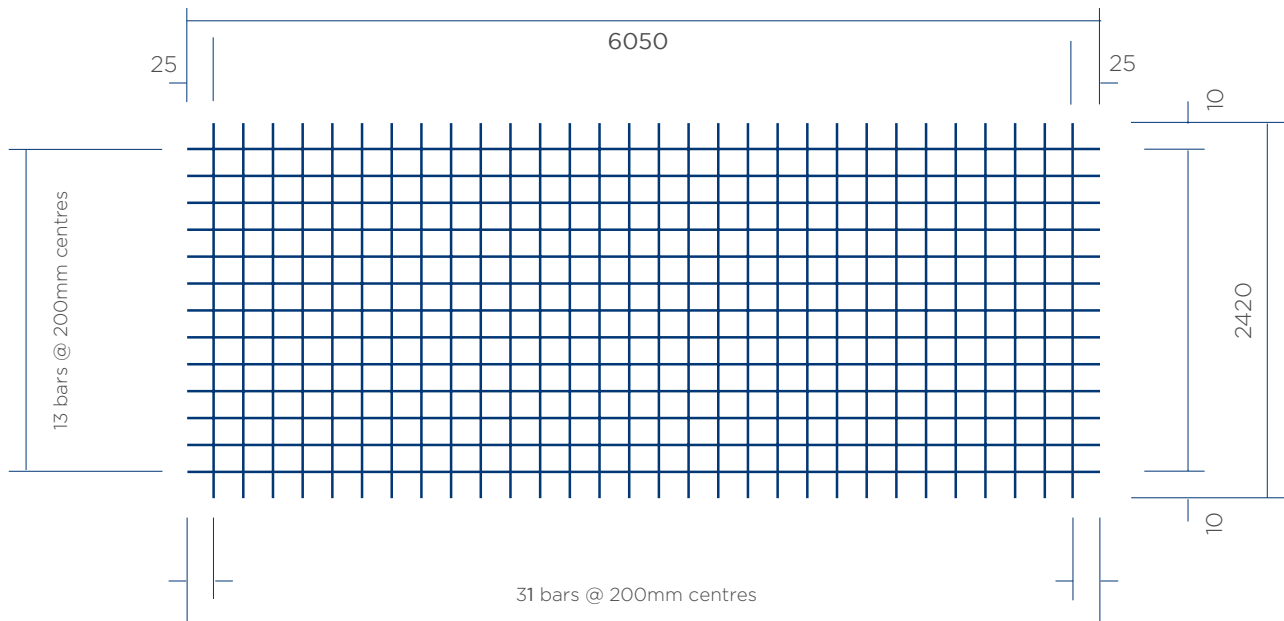

NB: Diagrams not to scale

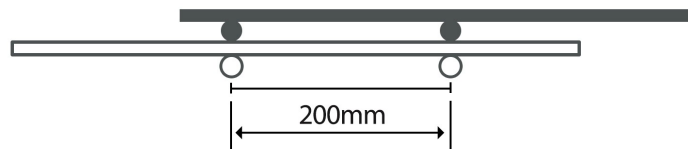

Each batch of Summit Steel & Wire Xtra-Ductile mesh undergoes rigorous testing to meet the AS/NZS 4671:2019 standard. Upon request, we provide batch test certificates for your records. Each mesh sheet comes with a unique identification tag that includes the product code and batch number, ensuring easy traceability. Please ensure this tag remains attached during installation. Standard lapping follows NZS 3101-2:2006, Clause 8.7.6 guidelines. Our 200mm splice length as shown above is an alternative solution having been tested and independently validated. Users must ensure that the correct splice is verified for each specific application.

January 2025

# MESH SPECIFICATIONS

Stock Code: SE820-500LGE



Product Description: **SE820-500LGE**

**XTRA-DUCTILE™ MESH (6.05M X 2.42M)**

Yield Stress: **≥ 500 MPa**

Cross Section: **251 mm<sup>2</sup>/m**

KN per metre width: **126 KN/m width**

Uniform Elongation: **10%**

Weight per SQM: **3.946 kg/m<sup>2</sup>**

Nett Cover: **12.76m<sup>2</sup>**

	LONG WIRE	CROSS WIRE
WIRE DIA (mm)	8.0	8.0
CENTRES (mm)	200	200
LENGTH (mm)	6050	2420
No. of WIRES	13	31
O/HANG (mm)	25	10
GROSS WEIGHT PER SHEET (Kg)	60.64	
WIRE KG/m	0.395	0.395
WEIGHT (Kg)	31.03	29.60
GROSS SHEET AREA (m <sup>2</sup> )	14.64	

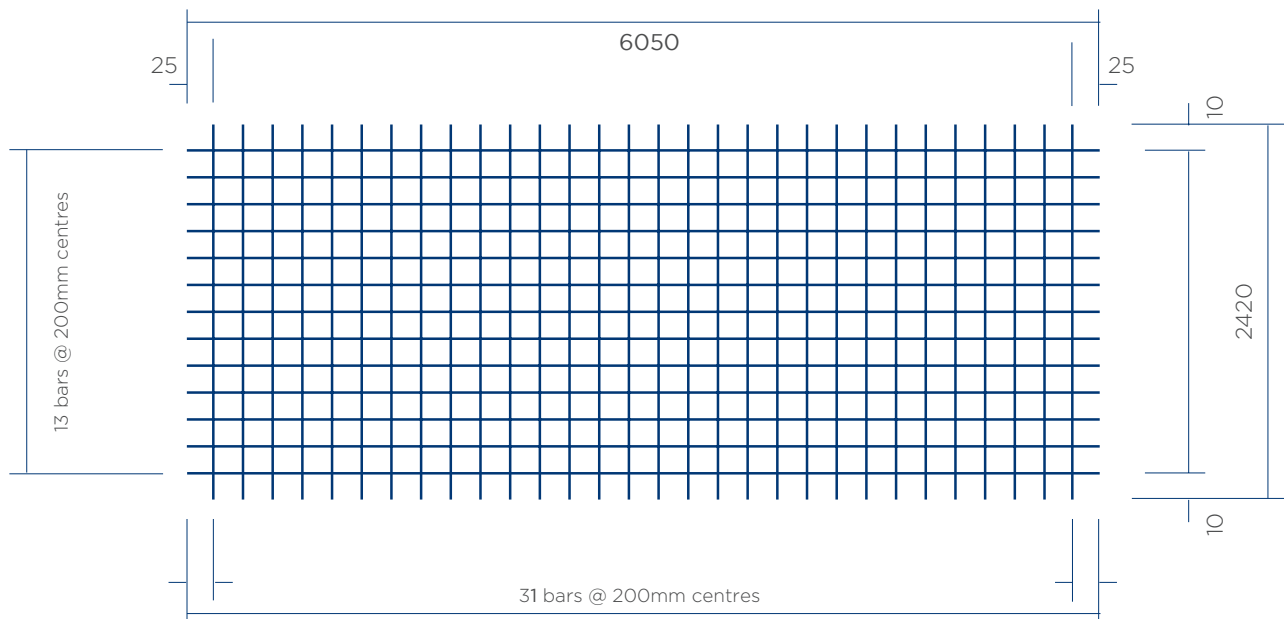

NB: Diagrams not to scale

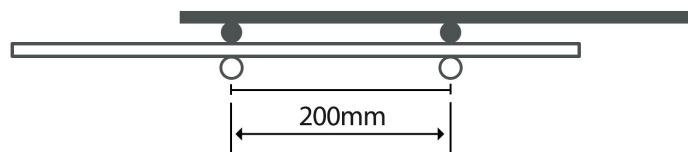

Each batch of Summit Steel & Wire Xtra-Ductile mesh undergoes rigorous testing to meet the AS/NZS 4671:2019 standard. Upon request, we provide batch test certificates for your records. Each mesh sheet comes with a unique identification tag that includes the product code and batch number, ensuring easy traceability. Please ensure this tag remains attached during installation. Standard lapping follows NZS 3101-2:2006, Clause 8.7.6 guidelines. Our 200mm splice length as shown above is an alternative solution having been tested and independently validated. Users must ensure that the correct splice is verified for each specific application.

January 2025

# MESH SPECIFICATIONS

Stock Code: SE920-500LGE



Product Description: **SE920-500LGE**

**XTRA-DUCTILE™ MESH (6.05M X 2.42M)**

Yield Stress: **≥ 500 MPa**

Cross Section: **318 mm<sup>2</sup>/m**

KN per metre width: **159 KN/m width**

Uniform Elongation: **10%**

Weight per SQM: **4.990 kg/m<sup>2</sup>**

Nett Cover: **12.76m<sup>2</sup>**

	LONG WIRE	CROSS WIRE
WIRE DIA (mm)	9.0	9.0
CENTRES (mm)	200	200
LENGTH (mm)	6050	2420
No. of WIRES	13	31
O/HANG (mm)	25	10
GROSS WEIGHT PER SHEET (Kg)	76.74	
WIRE KG/m	0.499	0.499
WEIGHT (Kg)	39.28	37.46
GROSS SHEET AREA (m <sup>2</sup> )	14.64	

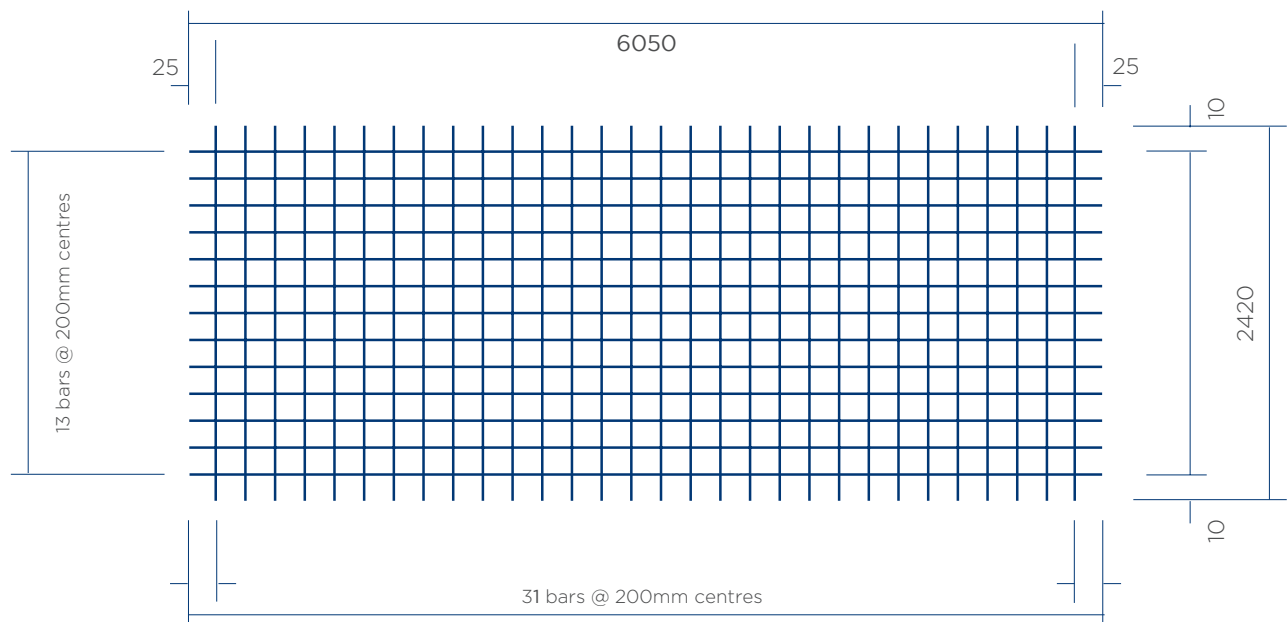

NB: Diagrams not to scale

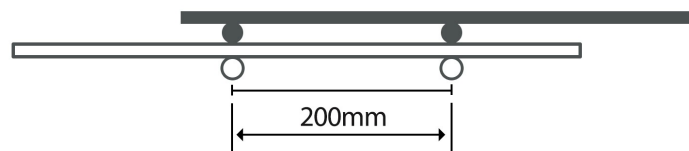

Each batch of Summit Steel & Wire Xtra-Ductile mesh undergoes rigorous testing to meet the AS/NZS 4671:2019 standard. Upon request, we provide batch test certificates for your records. Each mesh sheet comes with a unique identification tag that includes the product code and batch number, ensuring easy traceability. Please ensure this tag remains attached during installation. Standard lapping follows NZS 3101-2:2006, Clause 8.7.6 guidelines. Our 200mm splice length as shown above is an alternative solution having been tested and independently validated. Users must ensure that the correct splice is verified for each specific application.

January 2025