

*Let Us*

Show you our **reinforcing** range



[summitsteel.co.nz](http://summitsteel.co.nz)



Also available for download  
in our **Wire Fencing** and  
**Fastening** range.



# ABOUT SUMMIT STEEL & WIRE



Summit Steel & Wire is the product manufacturing and distribution business within the Euro Corporation Group. We specialise in Reinforcing Steel, Wire Fencing and Nail products.

The Summit Steel & Wire name represents our commitment in striving to be the best in our industry. We have a fantastic team of people who really make the difference and whilst we may not climb mountains every day, metaphorically this is exactly what we do to ensure you get your order on time, every time. Summit Steel & Wire is both representative of who we are and what we do.

We are very proud of our commitment to the merchant channel, and we continue to value the building and trust in our relationships with suppliers and customers.



# FOUNDATION PRODUCTS

Summit Steel & Wire both manufactures and sources a wide range of reinforcing steel and mesh products for use in New Zealand.



PRODUCT	Page
POLYTHENE BUILDERS FILM	4
TIE WIRE	4
PLASTIC BAR CHAIRS & STARTER SAFETY CAPS	5
PLAIN ROUND GRADE 500E ROD	5
LINKS & STIRRUPS	6
STARTERS	7
BAR GRADE 300E MILD	8
BAR GRADE 500E HIGH YIELD	8
XTRA-DUCTILE GRADE 500E MESH	9
HARD DRAWN MESH	9
MESH SPECIFICATIONS	10





PL250425



PL250250

## POLYTHENE BUILDERS FILM

Summit Steel & Wire's multipurpose builders film is commonly used in construction sites or any general areas where strong cover or underlay is required.

ITEM CODE	DESCRIPTION
PL250425	Polythene 250 Micron x 4m x 25m Black
PL250450	Polythene 250 Micron x 4m x 50m Black
PLTAPE	Poly Joining Tape 48mm x 30m

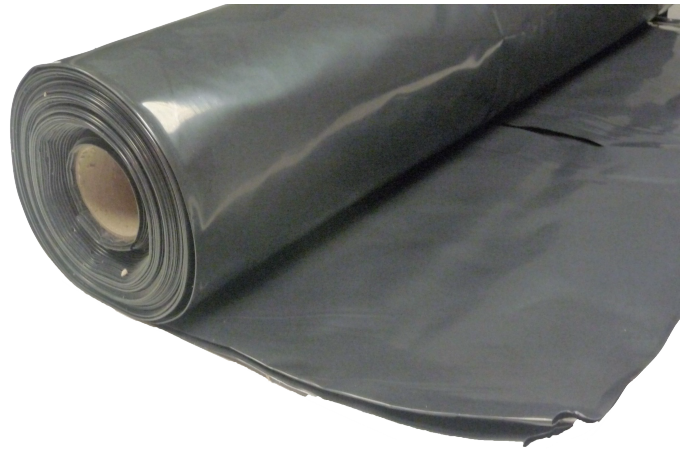

W230A



W300A

## TIE WIRE

Used in construction as binding wire.  
Available in Black Annealed and Galvanised.



W400A



W400GALV

ITEM CODE	DESCRIPTION	QUANTITY PER PACK
W230A	1.6mm Black Annealed x 230mm x 1kg Bundle	25
W300A	1.6mm Black Annealed x 300mm x 1kg Bundle	25
W400A	1.6mm Black Annealed x 400mm x 1kg Bundle	25
W230GALV	1.6mm Galvanised x 230mm x 1kg Bundle	25
W300GALV	1.6mm Galvanised x 300mm x 1kg Bundle	25
W400GALV	1.6mm Galvanised x 400mm x 1kg Bundle	25



PLASTIC BAR CHAIRS & STARTER SAFETY CAPS

Used for accurate placement of reinforcing mesh or bar.

ITEM CODE	DESCRIPTION	QUANTITY PER PACK	ORDER QUANTITY
PLCH001/20	25/40 Slab Mesh Support	20	1
PLCH006/20	50/65 Slab Mesh Support	20	1
PLCH001/100	25/40 Slab Mesh Support	100	1
PLCH006/100	50/65 Slab Mesh Support	100	1
PLCH020/100	75/90 Slab Mesh Support	100	1
PLCH030/50	85/100 Slab Mesh Support	50	1

REOSBC/20	10mm-32mm Safety Starter Cap	20	1
REOSBC/100	10mm-32mm Safety Starter Cap	100	1



PLCH001/100

PLCH006/100



PLCH020/100

PLCH030/50



REOSBC

PLAIN ROUND ROD

Available in 6m bars.

ITEM CODE	DESCRIPTION	PIECES PER BUNDLE
R6-500	HR6mm x 6m Plain Round Rod	50
R10-500	HR10mm x 6m Plain Round Rod	50
R12-300	R12mm x 6m Plain Round Rod	50
R12-500	HR12mm x 6m Plain Round Rod	50



R6-500



## LINKS & STIRRUPS

Summit Steel & Wire links & stirrups are GRADE 500E and manufactured using machinery that makes exact bends to meet NZ reinforcing specification. Stirrups are used for assembling of various reinforcing beams and assemblies. Custom made to order is available.

ITEM CODE	DESCRIPTION	PIECES PER BUNDLE
LHR690	HR6 Links x 90mm	25
LHR6150	HR6 Links x 150mm	25
LHR6200	HR6 Links x 200mm	25
LHR6250	HR6 Links x 250mm	25
LHR6300	HR6 Links x 300mm	25
LHR10150	HR10 Links x 150mm	25
LHR10200	HR10 Links x 200mm	25
LHR10250	HR10 Links x 250mm	25
LHR10300	HR10 Links x 300mm	25
STPHR61515	HR6 Stirrup 150 x 150mm	25
STPHR62010	HR6 Stirrup 200 x 100mm	25
STPHR62015	HR6 Stirrup 200 x 150mm	25
STPHR62020	HR6 Stirrup 200 x 200mm	25
STPHR62515	HR6 Stirrup 250 x 150mm	25
STPHR62525	HR6 Stirrup 250 x 250mm	25
STPHR63015	HR6 Stirrup 300 x 150mm	25
STPHR63020	HR6 Stirrup 300 x 200mm	25
STPHR63030	HR6 Stirrup 300 x 300mm	25
STPHR64515	HR6 Stirrup 450 x 150mm	25
STPHR101515	HR10 Stirrup 150x 150mm	25
STPHR102020	HR10 Stirrup 200 x 200mm	25
STPHR102515	HR10 Stirrup 250 x 150mm	25
STPHR102525	HR10 Stirrup 250 x 250mm	25
STPHR103030	HR10 Stirrup 300 x 300mm	25



LHR6150



LHR6250



LHR10250



LHR10300



STPHR63020

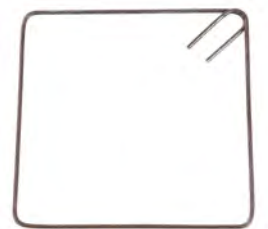

STPHR63030



STPHR102525



STPHR62010



## STARTERS

Used to tie concrete or masonry walls, slabs and footings.  
Can be custom made to order.

ITEM CODE	DESCRIPTION	PIECES PER BUNDLE
D12_600x600CNR	D12 Corner Bar 600 x 600mm	25
HD12_800x800CNR	HD12 Corner Bar 800 x 800mm	25
D16_650x650CNR	D16 Corner Bar 650 x 650mm	25
STRD101.2x150HB	D10 Starter 1.2m x 150mm Hooked Back	25
STRD121.2x150HB	D12 Starter 1.2m x 150mm Hooked Back	25
STRD10-1000	D10 Starter 1.0m Hooked	25
STRD10-1200	D10 Starter 1.2m Hooked	25
STRD10-1500	D10 Starter 1.5m Hooked	25
STRD12-1000	D12 Starter 1.0m Hooked	25
STRD12-1200	D12 Starter 1.2m Hooked	25
STRD12-1500	D12 Starter 1.5m Hooked	25
STRD101000150	D10 Starter 1.0m X 150mm 'L' Hook	25
STRD101200150	D10 Starter 1.2m x 150mm 'L' Hook	25
STRD101500150	D10 Starter 1.5m x 150mm 'L' Hook	25
STRD121000150	D12 Starter 1.0m x 150mm 'L' Hook	25
STRD121200150	D12 Starter 1.2m x 150mm 'L' Hook	25
STRD121500150	D12 Starter 1.5m x 150mm 'L' Hook	25

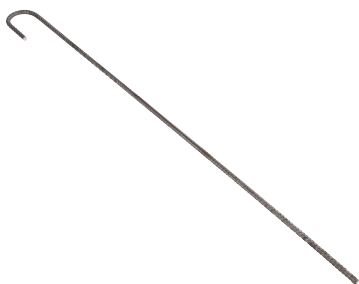

Hooked



Hooked Back



L Hook



BAR GRADE 300E MILD

We offer a complete range of grade 300E, deformed reinforcing steel rebar. Ask us if the size you require is not listed below.  
**Available in 6m bars.**

ITEM CODE	DESCRIPTION	KG/L	PIECES PER BUNDLE
D10-300	D10 x 6m Deformed Bar	3.7	276
D12-300	D12 x 6m Deformed Bar	5.3	192
D16-300	D16 x 6m Deformed Bar	9.5	108

**D10 -300 -> Blue**  
**D12-300 -> Yellow**  
**D16 -300 -> Green**

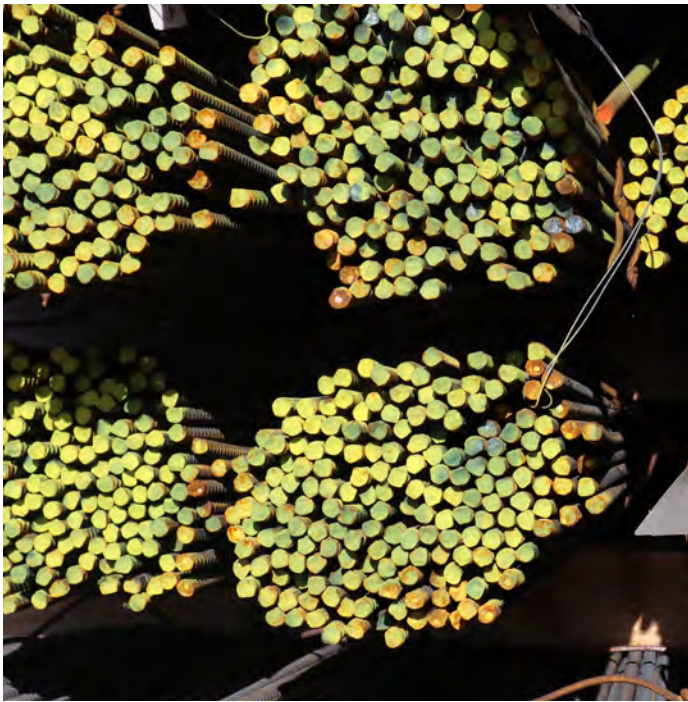

BAR GRADE 500E HIGH YIELD

We offer a complete range of grade 500E, deformed reinforcing steel rebar. Also known as high tensile rebar and reinforcing rod or bar. Ask us if the size you require is not listed below.  
**Available in 6m & 12m bars**

ITEM CODE	DESCRIPTION	KG/L	PIECES PER BUNDLE
D10-500	HD10 x 6m Deformed Bar	3.7	276
D12-500	HD12 x 6m Deformed Bar	5.3	192
D16-500	HD16 x 6m Deformed Bar	9.5	108
D20-500	HD20 x 6m Deformed Bar	14.8	Each
D25-500	HD25 x 6m Deformed Bar	23.1	Each
D32-500	HD32 x 6m Deformed Bar	37.9	Each

**All 500E -> Pink**  
**All 500E reinforcing bar is manufactured using the superior Micro Alloy (MA) process.**





## Xtra-Ductile GRADE 500E MESH

Summit Steel & Wire Xtra-Ductile™ is GRADE 500E steel mesh which is used primarily for crack control in reinforcement of concrete.

ITEM CODE	DESCRIPTION	KN/M	SHEET SIZE	NET CVR (m <sup>2</sup> )	WIRE DIAMETER	WEIGHT PER SHEET (KG)
SE620-500SMALL	SE620-500SMALL Xtra-Ductile Mesh	73	4.65m x 2.02m	7.92	6.1mm	22.86
SE620-500LGE	SE620 Xtra-Ductile Mesh Large	73	6.05m x 2.42m	12.76	6.1mm	35.25
SE720-500LGE	SE720 Xtra-Ductile Mesh Large	93	6.05m x 2.42m	12.76	7mm	46.42
SE820-500LGE	SE820 Xtra-Ductile Mesh Large	122	6.05m x 2.42m	12.76	8mm	60.64
SE920-500LGE	SE920 Xtra-Ductile Mesh Large	154	6.05m x 2.42m	12.76	9mm	76.74

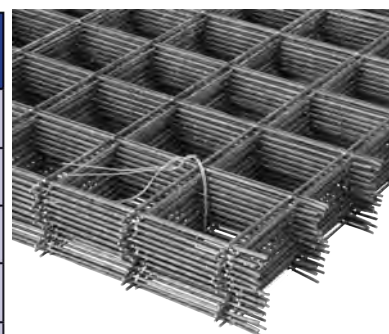

SE620-500SMALL

## HARD DRAWN MESH

Summit Steel & Wire hard drawn steel mesh is used for crack control in concrete where ductile mesh is not specified.

ITEM CODE	DESCRIPTION	KN/M	SHEET SIZE	NET CVR (m <sup>2</sup> )	WIRE DIAMETER	WEIGHT PER SHEET (KG)
M66810	668 Mesh Standard	41	4.56m x 1.97m	7.525	4mm	12.31
M665HANDY	665 Handy Mesh	71	1.97m x 0.98m	1.35	5.3mm	4.54
M66510	665 Mesh Standard	71	4.56m x 1.97m	7.525	5.3mm	21.61
M66310	663 Mesh Standard	101	4.56m x 1.97m	7.525	6.3mm	30.54
M66112	661 Mesh Large	143	5.91m x 1.97m	9.887	7.5mm	56.00
MD84/10	84 Mesh D/Edge	40	4.9m x 2.2m	10.08	5.6mm	15.89
MD147/10	147 Mesh D/Edge	71	4.9m x 2.2m	10.08	7.5mm	28.41

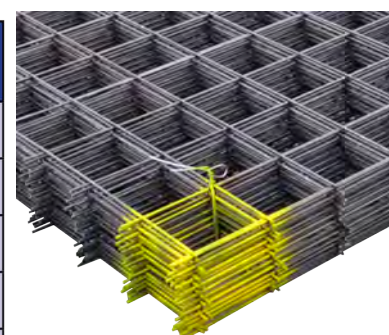

M66510

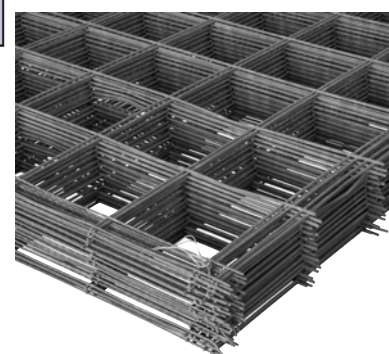

MD147/10

# MESH SPECIFICATIONS

Stock Code: SE620-500SMALL



Product Description: **SE620-500SMALL**

**XTRA-DUCTILE MESH (4.65M X 2.02M)**

Yield Stress:  $\geq 500 \text{ MPa}$

Cross Section: **146.1 mm<sup>2</sup>/m**

KN per metre width: **73 KN/m width**

Uniform Elongation:  $\geq 10\%$

Weight per SQM: **2.29 kg/m<sup>2</sup>**

Nett Cover: **7.92m<sup>2</sup>**

	LONG WIRE	CROSS WIRE
WIRE DIA (mm)	6.1	6.1
CENTRES (mm)	200	200
LENGTH (mm)	4650	2020
No. of WIRES	11	24
O/HANG (mm)	25	10
GROSS WEIGHT PER SHEET (Kg)	22.86	
WIRE KG/m	0.229	0.229
WEIGHT (Kg)	11.73	11.12
GROSS SHEET AREA (m <sup>2</sup> )	9.39	

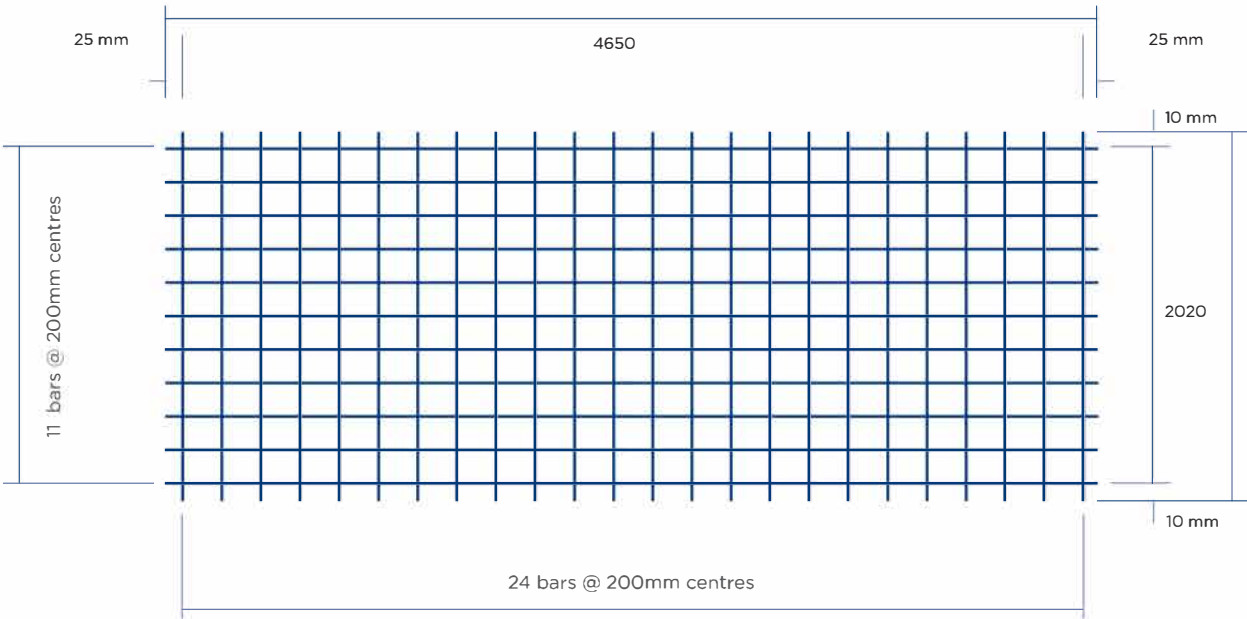

NB: Diagrams not to scale

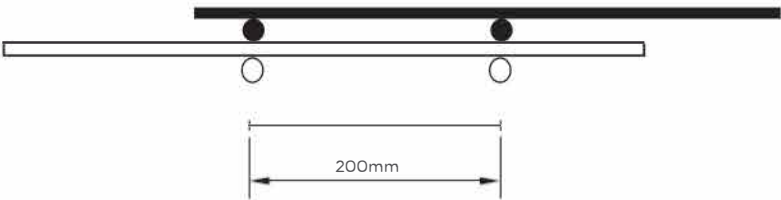

Each batch of Summit Steel & Wire Xtra-Ductile mesh undergoes rigorous testing to meet the AS/NZS 4671:2019 standard. Upon request, we provide batch test certificates for your records. Each mesh sheet comes with a unique identification tag that includes the product code and batch number, ensuring easy traceability. Please ensure this tag remains attached during installation. Standard lapping follows NZS 3101-2:2006, Clause 8.7.6 guidelines. Our 200mm splice length as shown above is an alternative solution having been tested and independently validated. Users must ensure that the correct splice is verified for each specific application.



# MESH SPECIFICATIONS

Stock Code: SE620-500LGE



Product Description: **SE620-500LGE**  
**XTRA-DUCTILE MESH (6.05M X 2.42M)**  
Yield Stress:  $\geq 500$  MPa  
Cross Section: **146.12 mm<sup>2</sup>/m**  
KN per metre width: **73 KN/m width**  
Uniform Elongation:  $\geq 10\%$   
Weight per SQM: **2.29 kg/m<sup>2</sup>**  
Nett Cover: **12.76m<sup>2</sup>**

	LONG WIRE	CROSS WIRE
WIRE DIA (mm)	6.1	6.1
CENTRES (mm)	200	200
LENGTH (mm)	6050	2420
No. of WIRES	13	31
O/HANG (mm)	25	10
GROSS WEIGHT PER SHEET (Kg)	35.25	
WIRE KG/m	0.229	0.229
WEIGHT (Kg)	18.04	17.21
GROSS SHEET AREA (m <sup>2</sup> )	14.64	

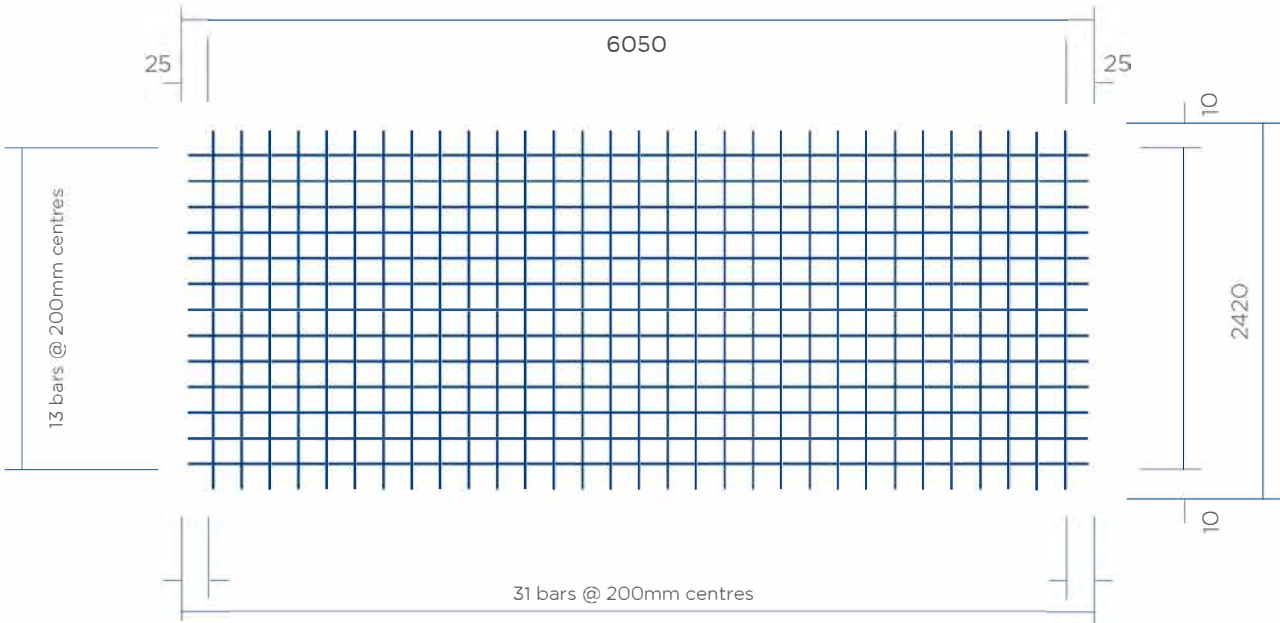

NB: Diagrams not to scale

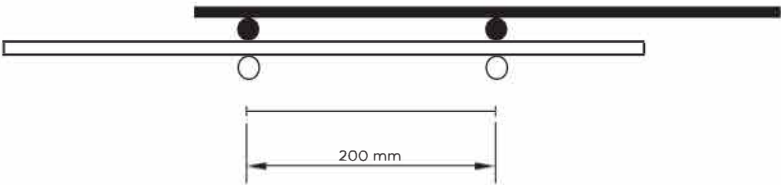

Each batch of Summit Steel & Wire Xtra-Ductile mesh undergoes rigorous testing to meet the AS/NZS 4671:2019 standard. Upon request, we provide batch test certificates for your records. Each mesh sheet comes with a unique identification tag that includes the product code and batch number, ensuring easy traceability. Please ensure this tag remains attached during installation. Standard lapping follows NZS 3101-2:2006, Clause 8.7.6 guidelines. Our 200mm splice length as shown above is an alternative solution having been tested and independently validated. Users must ensure that the correct splice is verified for each specific application.

# MESH SPECIFICATIONS

Stock Code: SE720-500LGE



Product Description: **SE720-500LGE**

**XTRA-DUCTILE™ MESH (6.05M X 2.42M)**

Yield Stress: **≥ 500 MPa**

Cross Section: **192 mm<sup>2</sup>/m**

KN per metre width: **96 KN/m width**

Uniform Elongation: **10%**

Weight per SQM: **3.02 kg/m<sup>2</sup>**

Nett Cover: **12.76m<sup>2</sup>**

	LONG WIRE	CROSS WIRE
WIRE DIA (mm)	7.0	7.0
CENTRES (mm)	200	200
LENGTH (mm)	6050	2420
No. of WIRES	13	31
O/HANG (mm)	25	10
GROSS WEIGHT PER SHEET (Kg)	46.42	
WIRE KG/m	0.302	0.302
WEIGHT (Kg)	23.76	22.66
GROSS SHEET AREA (m <sup>2</sup> )	14.64	

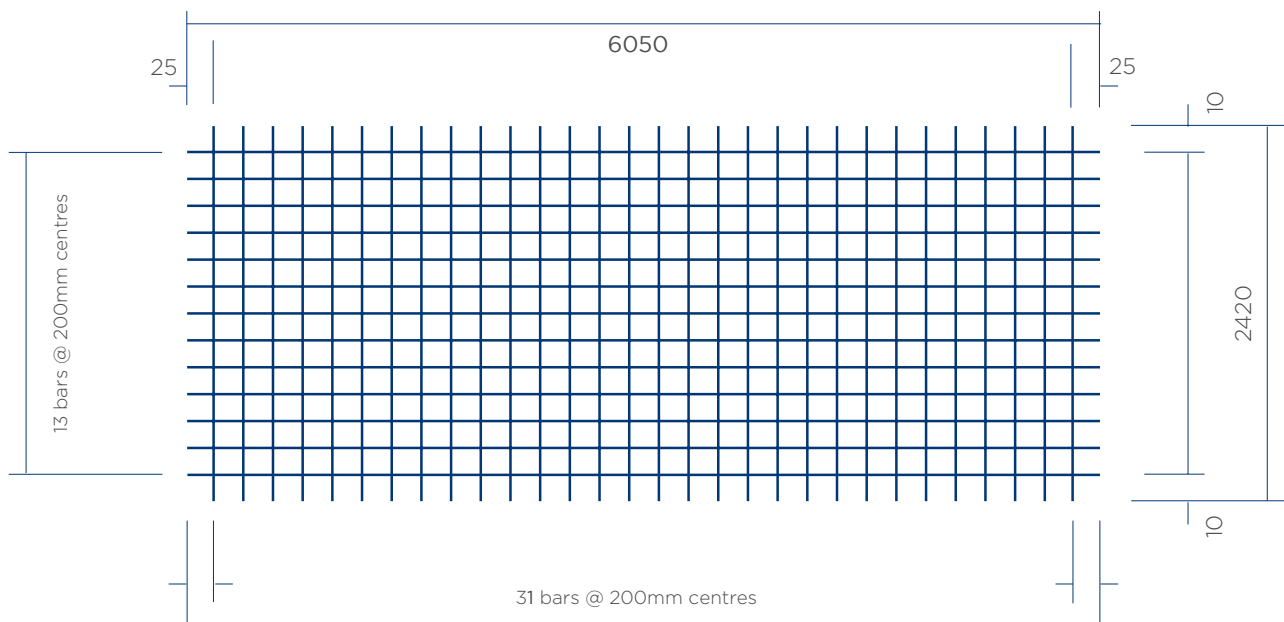

NB: Diagrams not to scale



Each batch of Summit Steel & Wire Xtra-Ductile mesh undergoes rigorous testing to meet the AS/NZS 4671:2019 standard. Upon request, we provide batch test certificates for your records. Each mesh sheet comes with a unique identification tag that includes the product code and batch number, ensuring easy traceability. Please ensure this tag remains attached during installation. Standard lapping follows NZS 3101-2:2006, Clause 8.7.6 guidelines. Our 200mm splice length as shown above is an alternative solution having been tested and independently validated. Users must ensure that the correct splice is verified for each specific application.

January 2025



# MESH SPECIFICATIONS

Stock Code: SE820-500LGE



Product Description: **SE820-500LGE**

**XTRA-DUCTILE™ MESH (6.05M X 2.42M)**

Yield Stress: **≥ 500 MPa**

Cross Section: **251 mm<sup>2</sup>/m**

KN per metre width: **126 KN/m width**

Uniform Elongation: **10%**

Weight per SQM: **3.946 kg/m<sup>2</sup>**

Nett Cover: **12.76m<sup>2</sup>**

	LONG WIRE	CROSS WIRE
WIRE DIA (mm)	8.0	8.0
CENTRES (mm)	200	200
LENGTH (mm)	6050	2420
No. of WIRES	13	31
O/HANG (mm)	25	10
GROSS WEIGHT PER SHEET (Kg)	60.64	
WIRE KG/m	0.395	0.395
WEIGHT (Kg)	31.03	29.60
GROSS SHEET AREA (m <sup>2</sup> )	14.64	

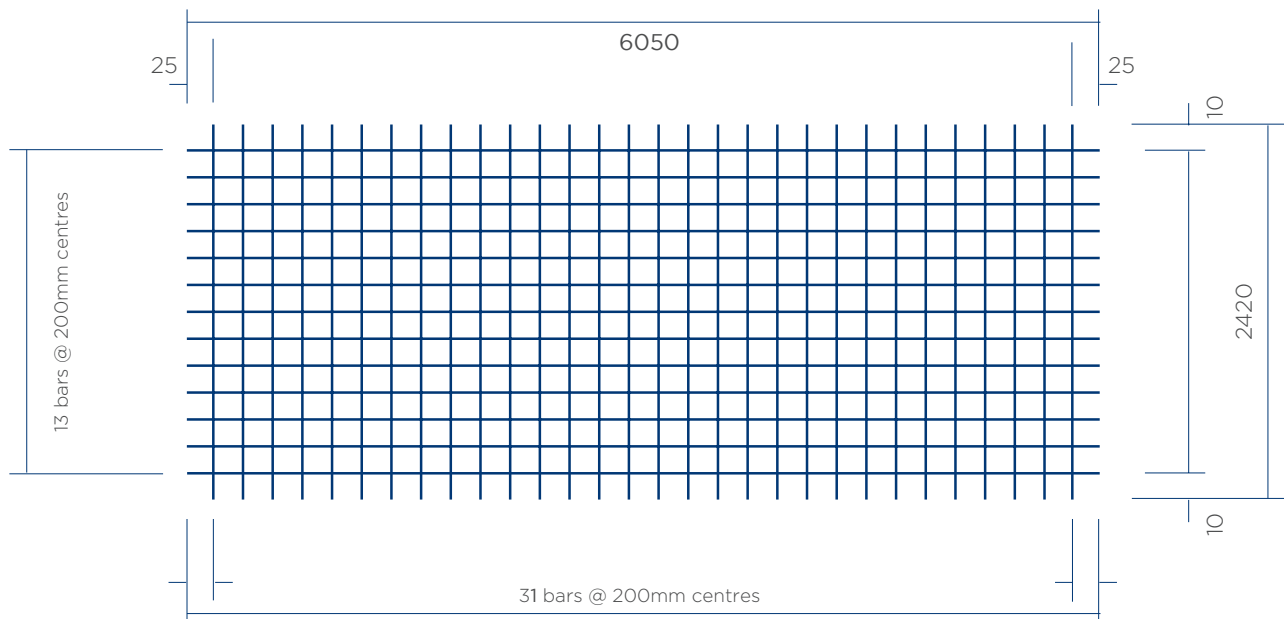

NB: Diagrams not to scale

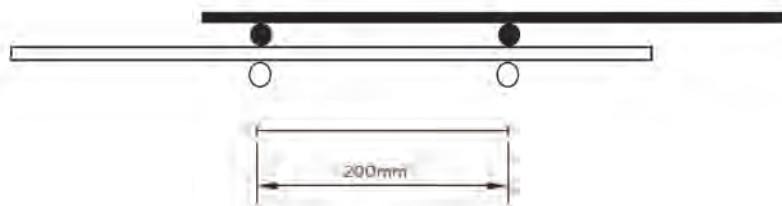

Each batch of Summit Steel & Wire Xtra-Ductile mesh undergoes rigorous testing to meet the AS/NZS 4671:2019 standard. Upon request, we provide batch test certificates for your records. Each mesh sheet comes with a unique identification tag that includes the product code and batch number, ensuring easy traceability. Please ensure this tag remains attached during installation. Standard lapping follows NZS 3101-2:2006, Clause 8.7.6 guidelines. Our 200mm splice length as shown above is an alternative solution having been tested and independently validated. Users must ensure that the correct splice is verified for each specific application.

January 2025

# MESH SPECIFICATIONS

Stock Code: SE920-500LGE



Product Description: **SE920-500LGE**

**XTRA-DUCTILE™ MESH (6.05M X 2.42M)**

Yield Stress: **≥ 500 MPa**

Cross Section: **318 mm<sup>2</sup>/m**

KN per metre width: **159 KN/m width**

Uniform Elongation: **10%**

Weight per SQM: **4.990 kg/m<sup>2</sup>**

Nett Cover: **12.76m<sup>2</sup>**

	LONG WIRE	CROSS WIRE
WIRE DIA (mm)	9.0	9.0
CENTRES (mm)	200	200
LENGTH (mm)	6050	2420
No. of WIRES	13	31
O/HANG (mm)	25	10
GROSS WEIGHT PER SHEET (Kg)	76.74	
WIRE KG/m	0.499	0.499
WEIGHT (Kg)	39.28	37.46
GROSS SHEET AREA (m <sup>2</sup> )	14.64	

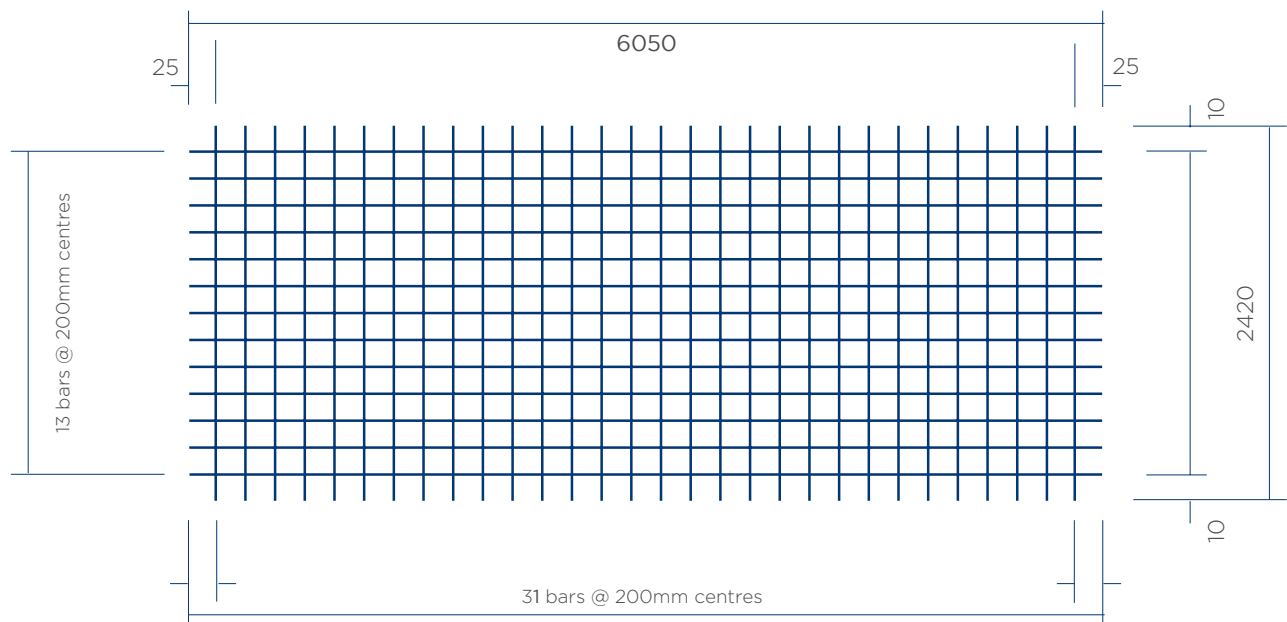

NB: Diagrams not to scale

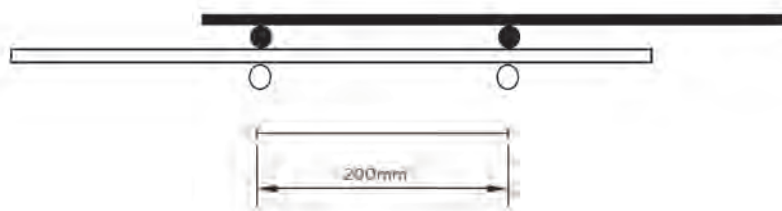

Each batch of Summit Steel & Wire Xtra-Ductile mesh undergoes rigorous testing to meet the AS/NZS 4671:2019 standard. Upon request, we provide batch test certificates for your records. Each mesh sheet comes with a unique identification tag that includes the product code and batch number, ensuring easy traceability. Please ensure this tag remains attached during installation. Standard lapping follows NZS 3101-2:2006, Clause 8.7.6 guidelines. Our 200mm splice length as shown above is an alternative solution having been tested and independently validated. Users must ensure that the correct splice is verified for each specific application.

January 2025



# MESH SPECIFICATIONS

Stock Code: M66810



Product Description: **668 MESH STANDARD**  
(4.56M X 1.97M)

Max. Tensile: **775 MPa**

Min. Tensile: **575 MPa**

Min. Proof Stress: **485 MPa**

Cross Section: **83.8 mm<sup>2</sup>/m**

KN per metre width: **41 KN/m width**

Weight per SQM: **1.31 kg/m<sup>2</sup>**

Nett Cover: **7.525m<sup>2</sup>**

	LONG WIRE	CROSS WIRE
WIRE DIA (mm)	4.0	4.0
CENTRES (mm)	150	150
LENGTH (mm)	4560	1970
No. of WIRES	14	31
O/HANG (mm)	40	10
GROSS WEIGHT PER SHEET (Kg)	12.31	
GROSS SHEET AREA (m <sup>2</sup> )	8.98	

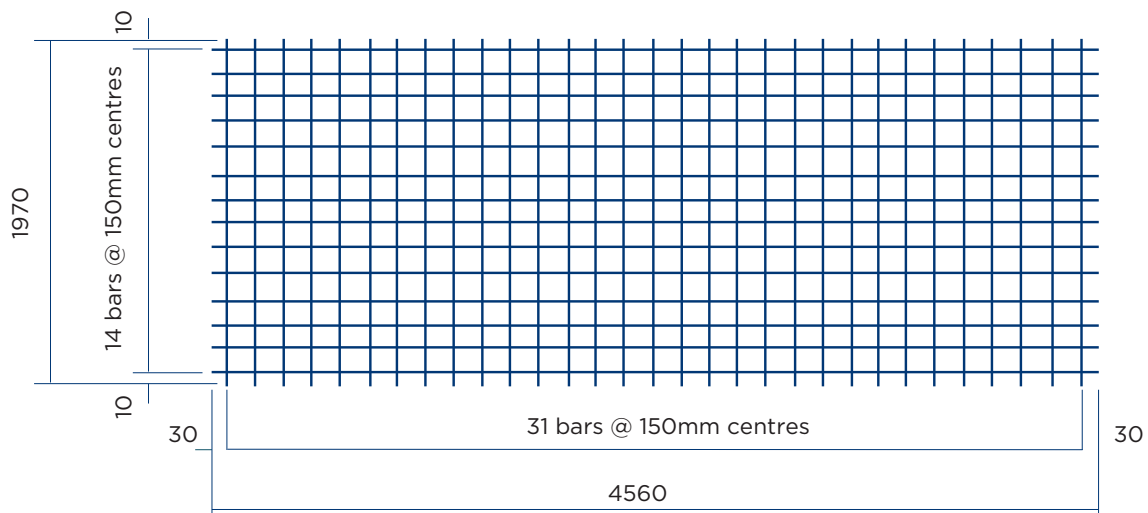

NB: Diagrams not to scale

## LAPPING DETAIL

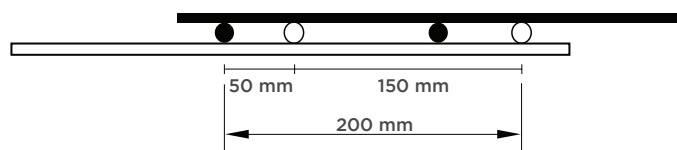

NB: Based on NZS3101

# MESH SPECIFICATIONS

Stock Code: M665HANDY



Product Description: **665 HANDY MESH**  
(1.95M X 0.9M)

Max. Tensile: **775 MPa**

Min. Tensile: **575 MPa**

Min. Proof Stress: **485 MPa**

Cross Section: **147.1 mm<sup>2</sup>/m**

KN per metre width: **71 KN/m width**

Weight per SQM: **2.31 kg/m<sup>2</sup>**

Nett Cover: **1.23m<sup>2</sup>**

	LONG WIRE	CROSS WIRE
WIRE DIA (mm)	5.3	5.3
CENTRES (mm)	150	150
LENGTH (mm)	1950	900
No. of WIRES	7	14
O/HANG (mm)	NIL	NIL
GROSS WEIGHT PER SHEET (Kg)	4.54kg	
GROSS SHEET AREA (m <sup>2</sup> )	1.76	

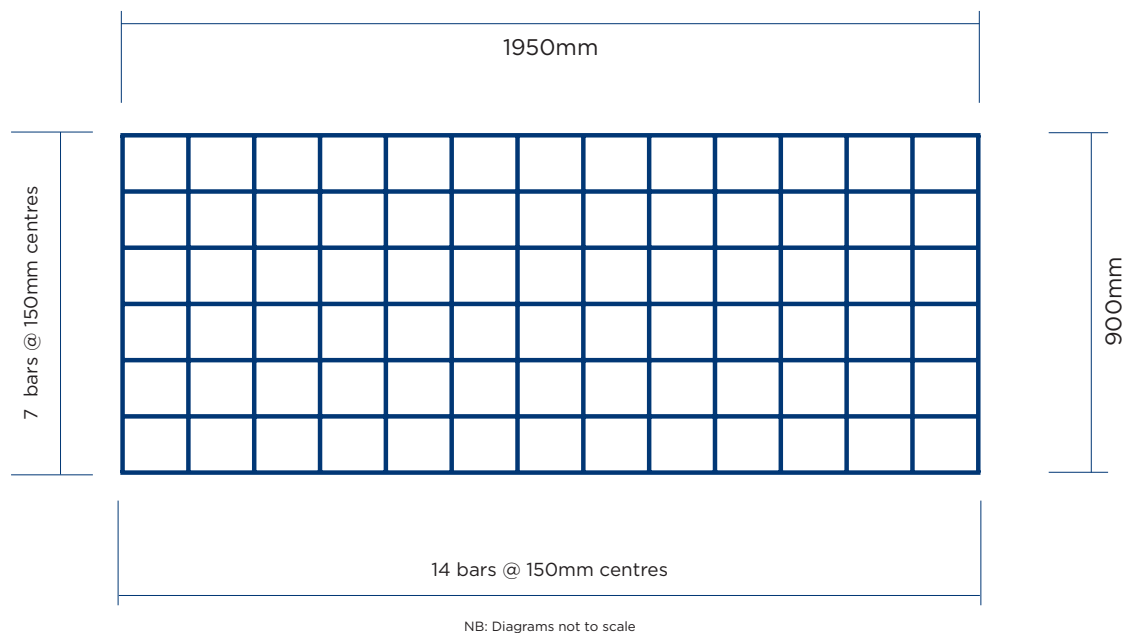

## LAPPING DETAIL

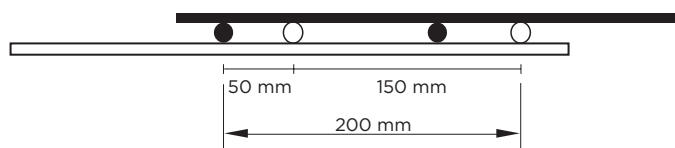

NB: Based on NZS3101



# MESH SPECIFICATIONS

Stock Code: M66510



Product Description: **665 MESH STANDARD**  
(4.56M x 1.97M)

Max. Tensile: **775 MPa**

Min. Tensile: **575 MPa**

Min. Proof Stress: **485 MPa**

Cross Section: **147.1 mm<sup>2</sup>/m**

KN per metre width: **71 KN/m width**

Weight per SQM: **2.31 kg/m<sup>2</sup>**

Nett Cover: **7.525m<sup>2</sup>**

	LONG WIRE	CROSS WIRE
WIRE DIA (mm)	5.3	5.3
CENTRES (mm)	150	150
LENGTH (mm)	4560	1970
No. of WIRES	14	31
O/HANG (mm)	30	10
GROSS WEIGHT PER SHEET (Kg)	21.61	
GROSS SHEET AREA (m <sup>2</sup> )	8.98	

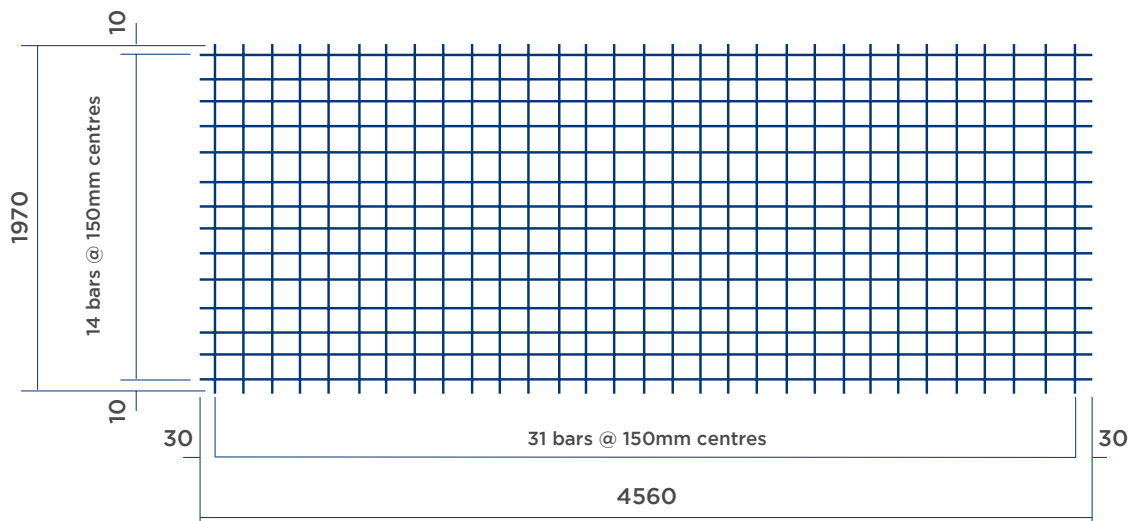

NB: Diagrams not to scale

## LAPPING DETAIL

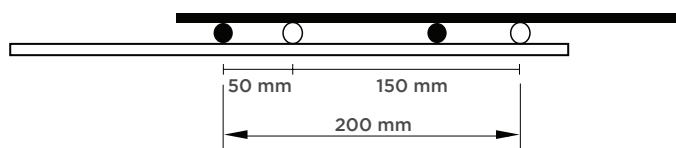

NB: Based on NZS3101

# MESH SPECIFICATIONS

Stock Code: M66310



Product Description: **663 MESH STANDARD**  
(4.56M x 1.97M)

Max. Tensile: **775 MPa**

Min. Tensile: **575 MPa**

Min. Proof Stress: **485 MPa**

Cross Section: **207.8 mm<sup>2</sup>/m**

KN per metre width: **101 KN/m width**

Weight per SQM: **3.26 kg/m<sup>2</sup>**

Nett Cover: **7.525m<sup>2</sup>**

	LONG WIRE	CROSS WIRE
WIRE DIA (mm)	6.3	6.3
CENTRES (mm)	150	150
LENGTH (mm)	4560	1970
No. of WIRES	14	31
O/HANG (mm)	30	10
GROSS WEIGHT PER SHEET (Kg)	30.54	
GROSS SHEET AREA (m <sup>2</sup> )	8.98	

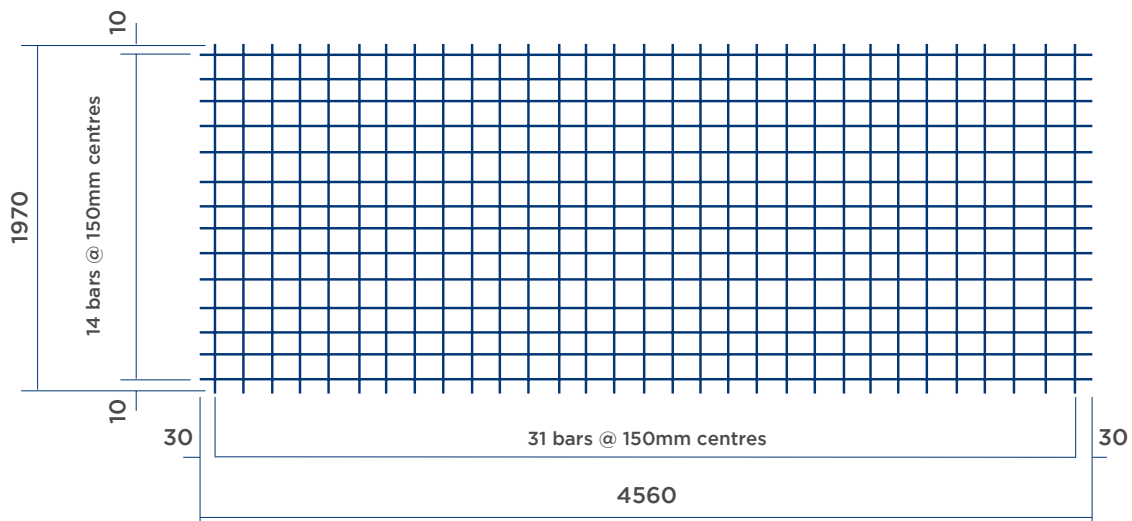

NB: Diagrams not to scale

## LAPPING DETAIL

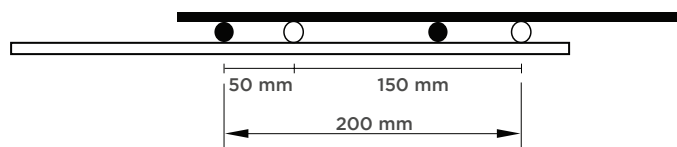

NB: Based on NZS3101



# MESH SPECIFICATIONS

Stock Code: M66112



Product Description: **661 MESH LARGE**  
(5.91M X 1970M)

Max. Tensile: **775 MPa**

Min. Tensile: **575 MPa**

Min. Proof Stress: **485 MPa**

Cross Section: **294.5 mm<sup>2</sup>/m**

KN per metre width: **143 KN/m width**

Weight per SQM: **4.624 kg/m<sup>2</sup>**

Nett Cover: **9.887m<sup>2</sup>**

	LONG WIRE	CROSS WIRE
WIRE DIA (mm)	7.5	7.5
CENTRES (mm)	150	150
LENGTH (mm)	5910	1970
No. of WIRES	14	40
O/HANG (mm)	30	10
GROSS WEIGHT PER SHEET (Kg)	56	
GROSS SHEET AREA (m <sup>2</sup> )	11.6	

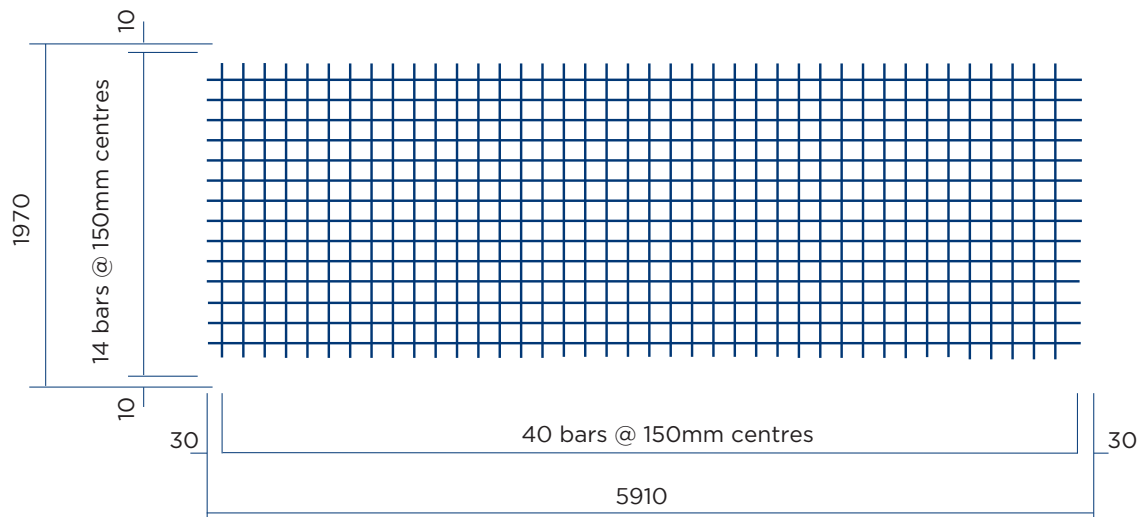

NB: Diagrams not to scale

## LAPPING DETAIL

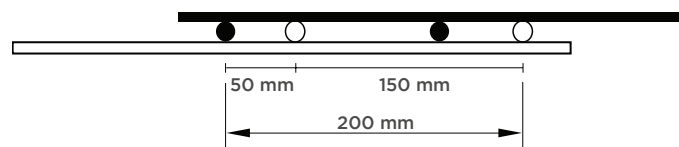

NB: Based on NZS3101

# MESH SPECIFICATIONS

Stock Code: MD84/10



Product Description: **D84/10 DOUBLE EDGE MESH (4.98M X 2.22M)**

Max. Tensile: **775 MPa**

Min. Tensile: **575 MPa**

Min. Proof Stress: **485 MPa**

Cross Section: **82.1 mm<sup>2</sup>/m**

KN per metre width: **40 KN/m width**

Weight per SQM: **1.29 kg/m<sup>2</sup>**

Nett Cover: **10.080m<sup>2</sup>**

	LONG WIRE 1	LONG WIRE 2	CROSS WIRE
WIRE DIA (mm)	5.6	4.0	5.6
CENTRES (mm)	300	50	300
LENGTH (mm)	4980	4980	2220
No. of WIRES	6	4	19
O/HANG (mm)	40	40	40
GROSS WEIGHT PER SHEET (Kg)	15.89		
GROSS SHEET AREA (m <sup>2</sup> )	11.06		

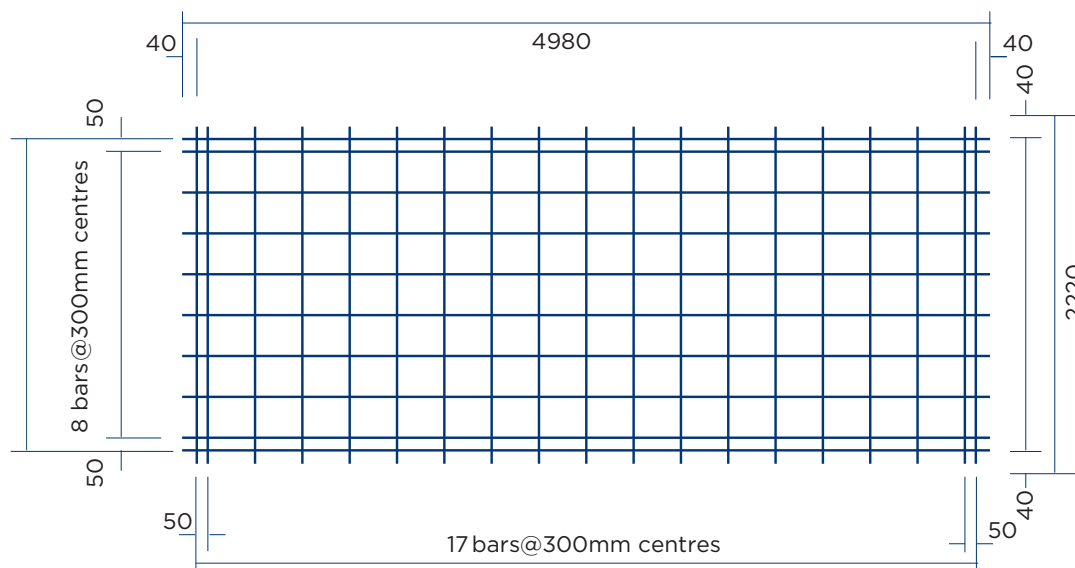

NB: Diagrams not to scale

## LAPPING DETAIL

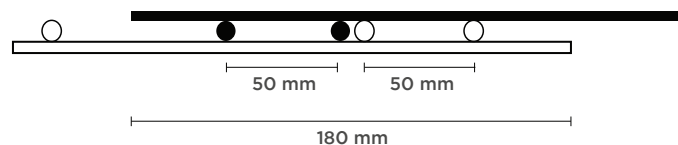



# MESH SPECIFICATIONS

Stock Code: MD147/10



Product Description: **D147/10 DOUBLE EDGE MESH (4.98 X 2.22M)**

Max. Tensile: **775 MPa**

Min. Tensile: **575 MPa**

Min. Proof Stress: **485 MPa**

Cross Section: **147.3 mm<sup>2</sup>/m**

KN per metre width: **71 KN/m width**

Weight per SQM: **2.31 kg/m<sup>2</sup>**

Nett Cover: **10.080m<sup>2</sup>**

	LONG WIRE 1	LONG WIRE 2	CROSS WIRE
WIRE DIA (mm)	7.5	5.3	7.5
CENTRES (mm)	300	50	300
LENGTH (mm)	4980	4980	2220
No. of WIRES	6	4	19
O/HANG (mm)	40	40	40
GROSS WEIGHT PER SHEET (Kg)	28.41		
GROSS SHEET AREA (m <sup>2</sup> )	11.06		

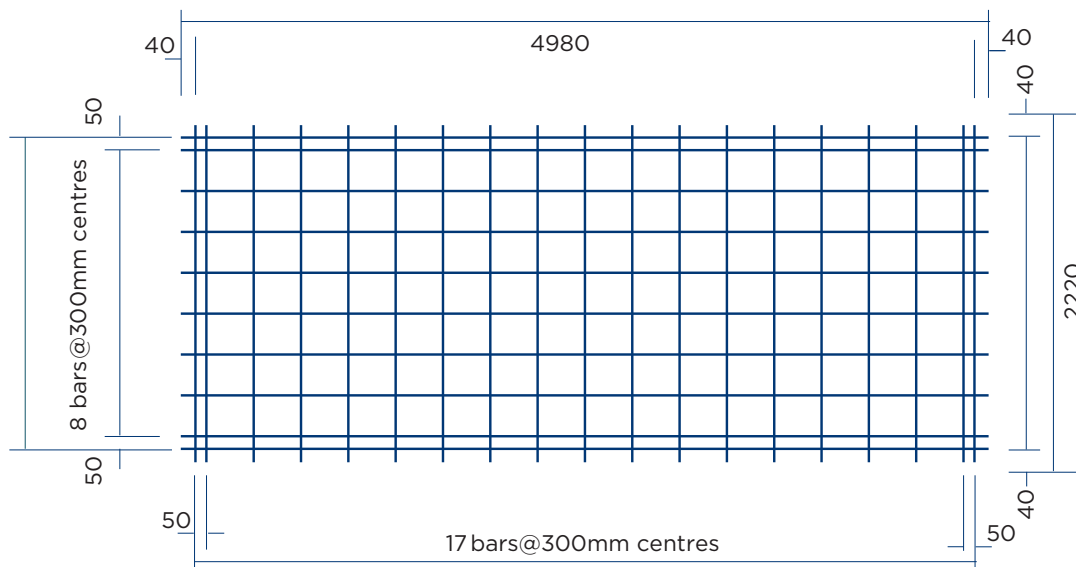

NB: Diagrams not to scale

## LAPPING DETAIL

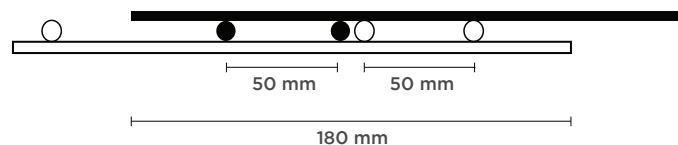



**P** +64 (09) 271 1627

**W** [summitsteel.co.nz](http://summitsteel.co.nz)

Details in this catalogue are subject to change, updated Sept 2020. For the latest version, refer to our website, [summitsteel.co.nz](http://summitsteel.co.nz)

